

guide ring F06

seal spec

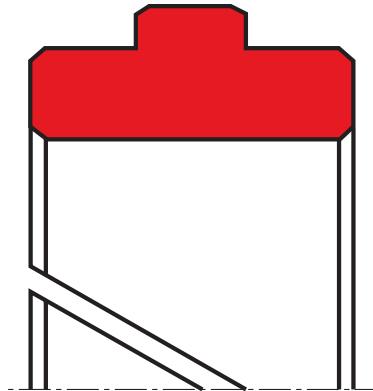

description

with integrated collar on outside diameter, for rod application. split and non split design available.

application



not bolded symbols; please consult our technical for application limitations

category of profile

machined only.

application:

for the guidance of pistons in hydraulic and pneumatic cylinders. in the case of pneumatic systems the application is, however, restricted to lubricated air.

operating parameters & material

diameter range: up to 600 mm

material	temperature	max. surface speed	max. specific load
s-mart POM ²	-50 °C ... +100 °C	4,0 m/s	25 N/mm ²
s-mart PA ²	-40 °C ... +100 °C	4,0 m/s	25 N/mm ²
s-mart PTFE glass	-200 °C ... +200 °C	4,0 m/s	3 N/mm ²
s-mart PTFE bronze	-200 °C ... +200 °C	5,0 m/s	4,5 N/mm ²
s-mart TEX	-40 °C ... +130 °C	1,0 m/s	90 N/mm ²

the stated operation conditions represent general indications. it is recommended not to use all maximum values simultaneously. surface speed limits apply only to the presence of adequate lubrication film.

² POM up to ø260 mm, PA above ø260 mm

tolerance recommendation

seal housing tolerances

Ød	f8
Ød1	H8
ØD	H10

**seal & housing recommendations**

please note that we are able to produce those profiles to your specific need or any non standard housing. for detail measurements, please see seal-mart catalog...

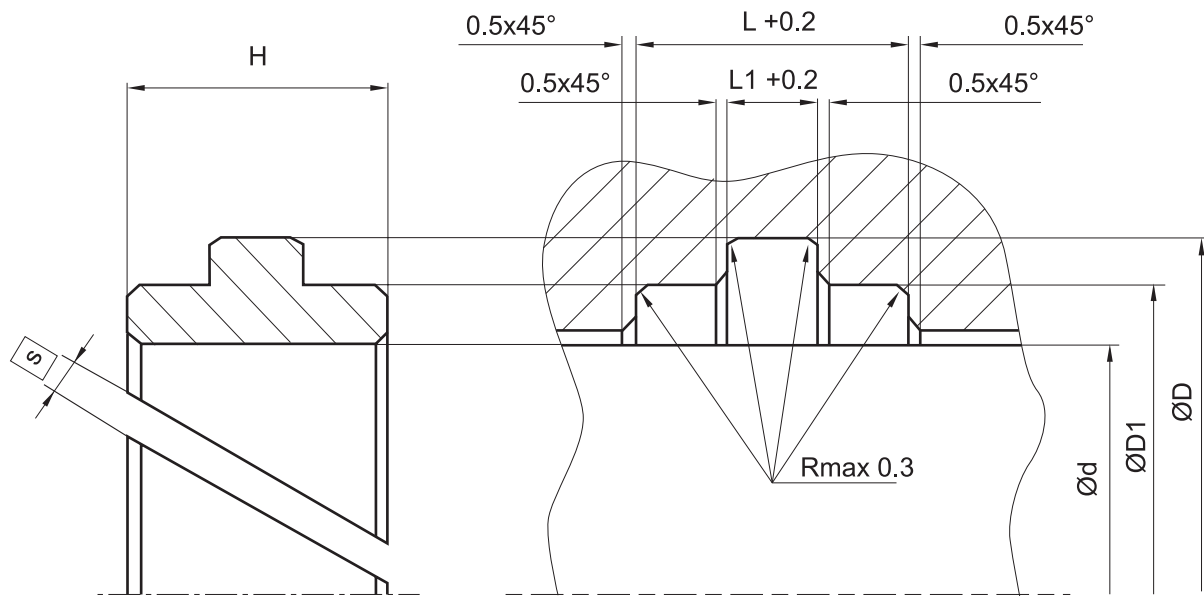
**variations:**

- cutting gap width $s=...mm$
- endless

don't hesitate to contact our technical department for further information or for special requirements (temperature, speed etc.), so that suitable materials and/or designs can be recommended.